

# Wall mounted extractor hood, box

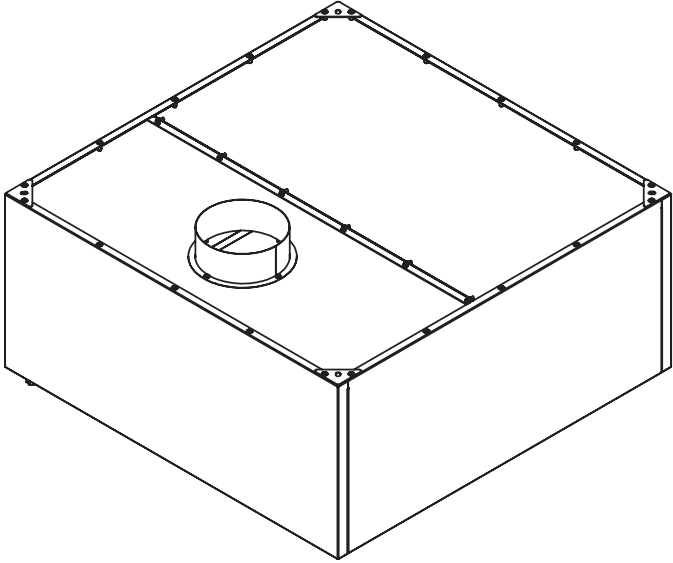

## Parts

Panel A – 2 pcs.

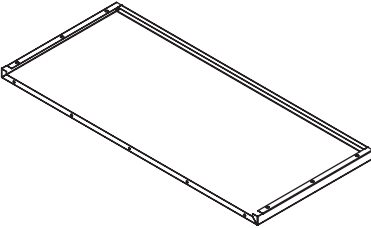

Ceiling A – 1 pc.

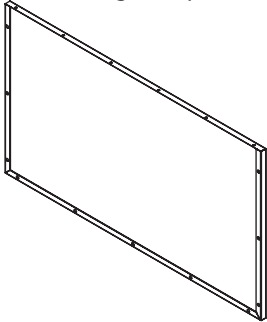

Ceiling B – 1 pc.

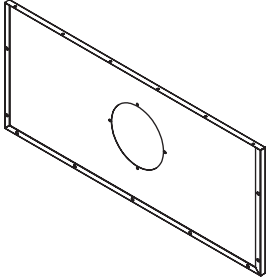

Panel B – 2 pcs.

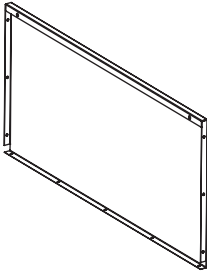

Top bracket filter – 1 pc.

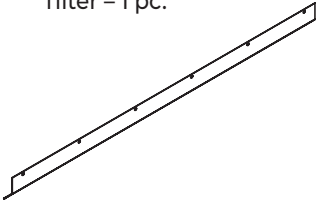

Exhaust pipe – 1 pc.

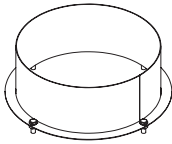

Dray tray connected to the bottom filter support – 1 pc.

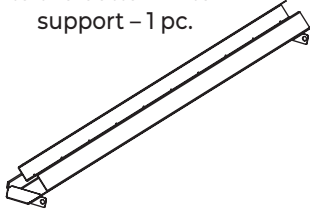

Cover – 2 pcs.

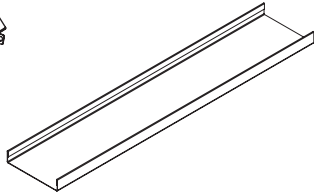

Handle – 4 pcs.

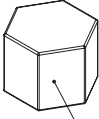
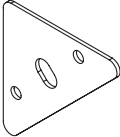

Nut 1/2" – 1 pc.

Washer screw M6x16 – 35 pcs.



Nut M6 – 10 pcs.



Hexagon head screw M6x16 – 10 pcs.



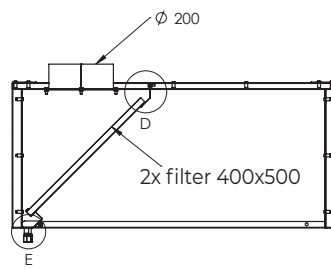
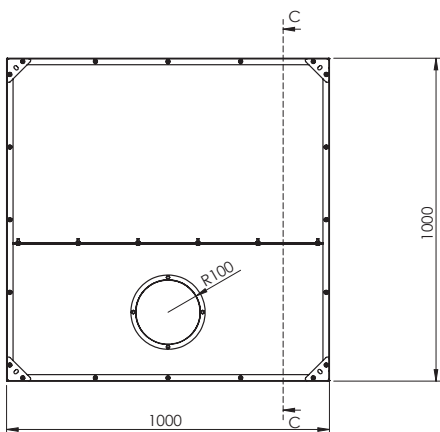
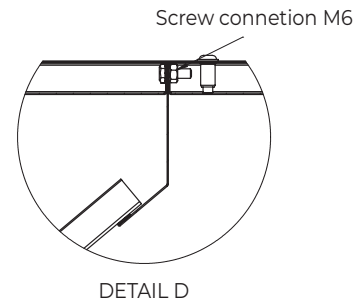
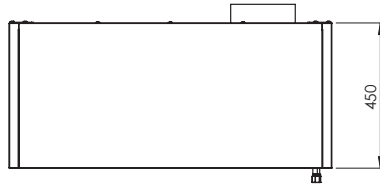
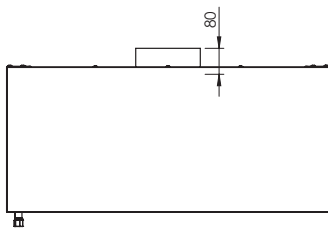
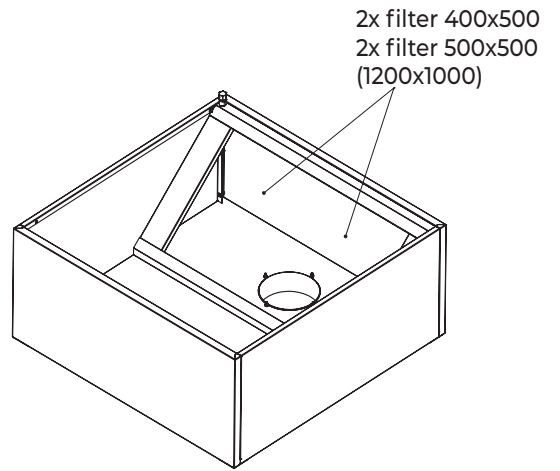
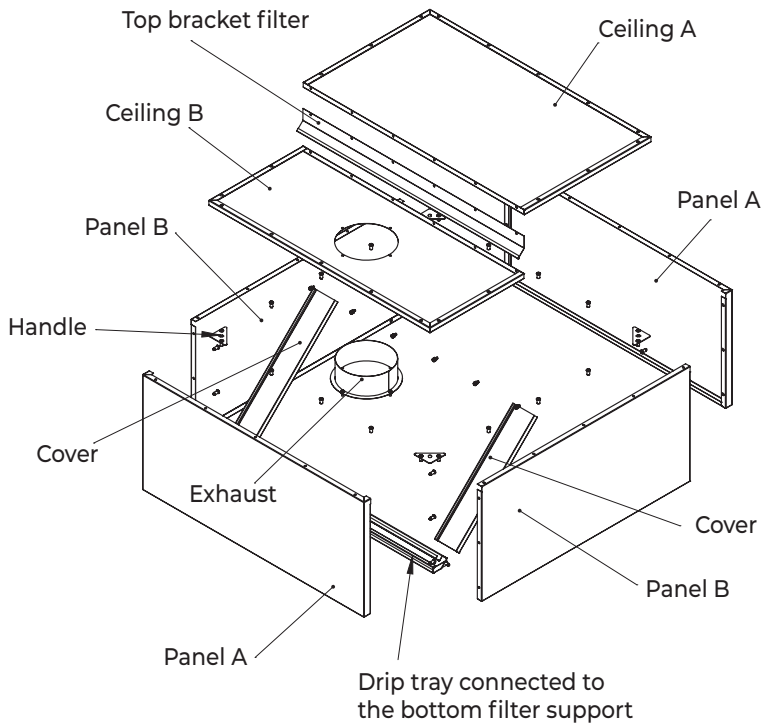

CROSS SECTION C-C

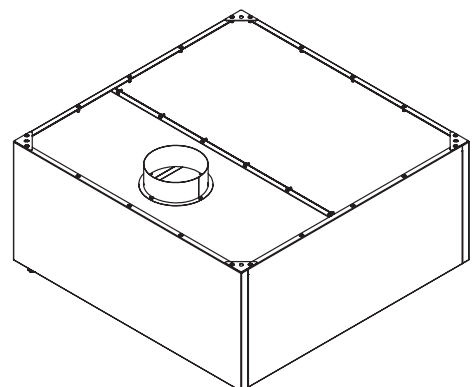
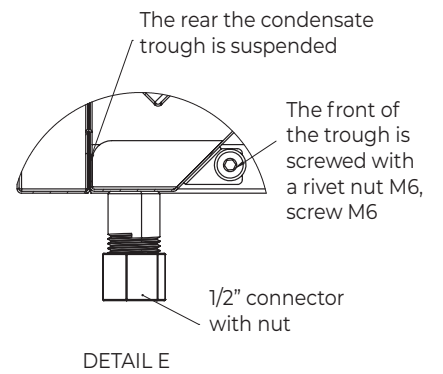

# Step I

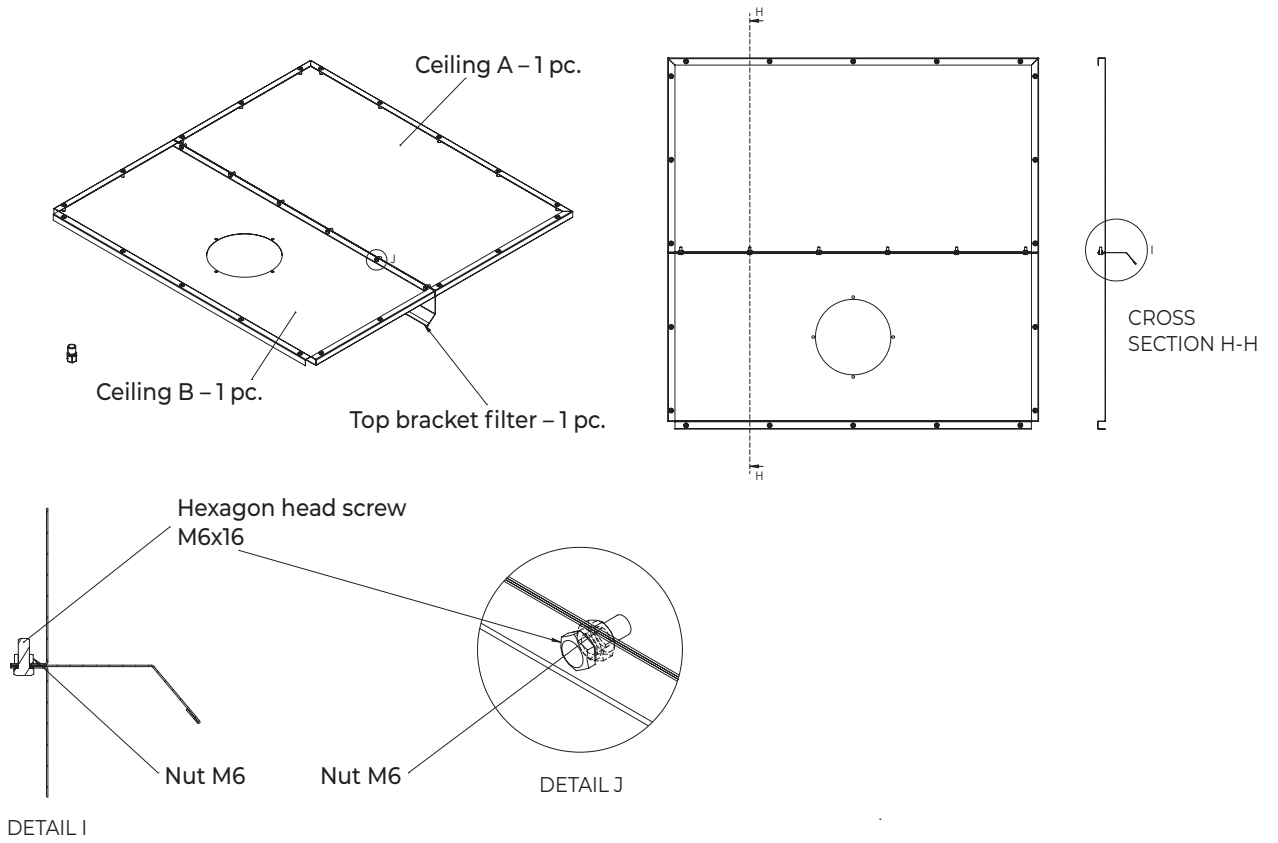

# Step II

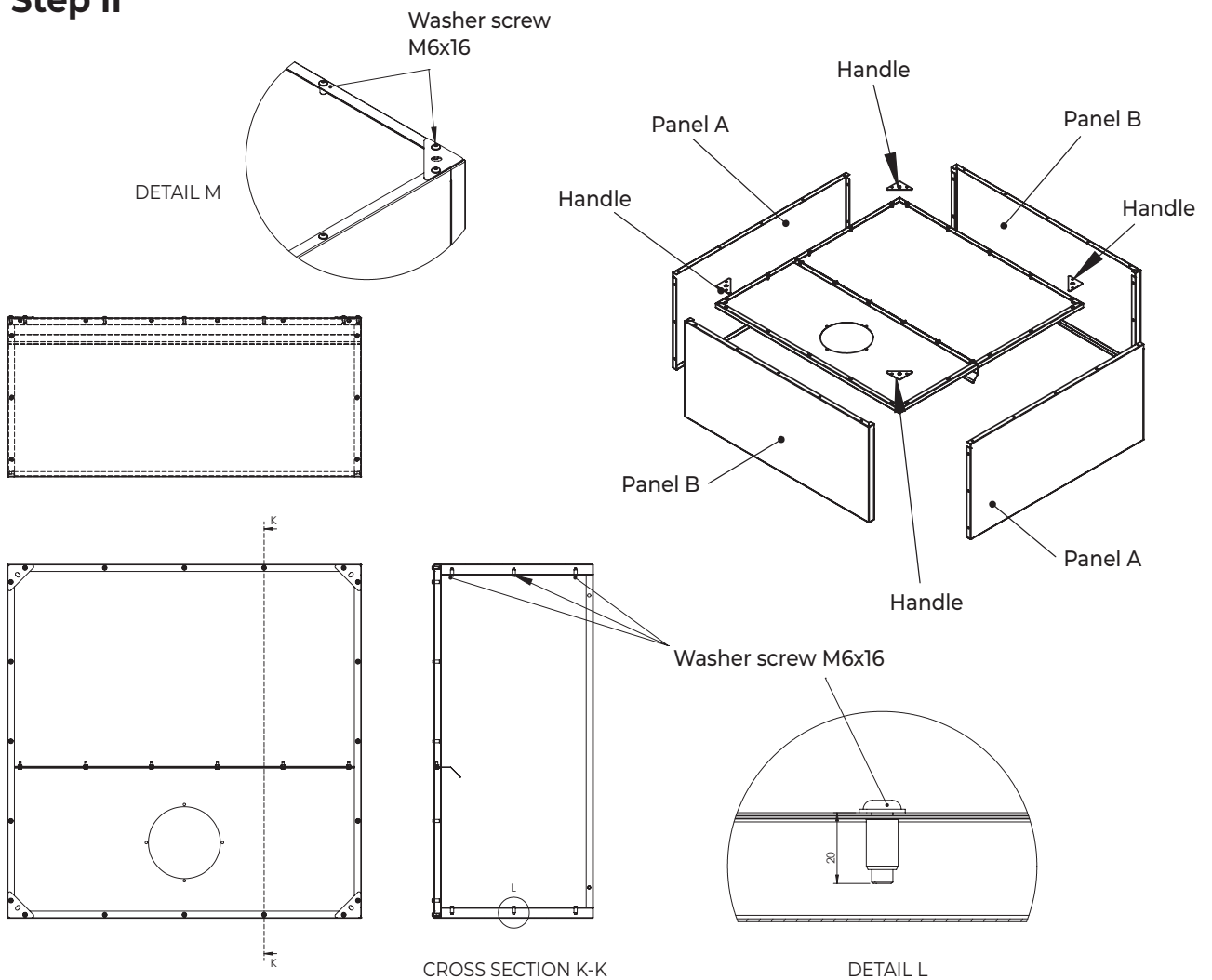

### Step III

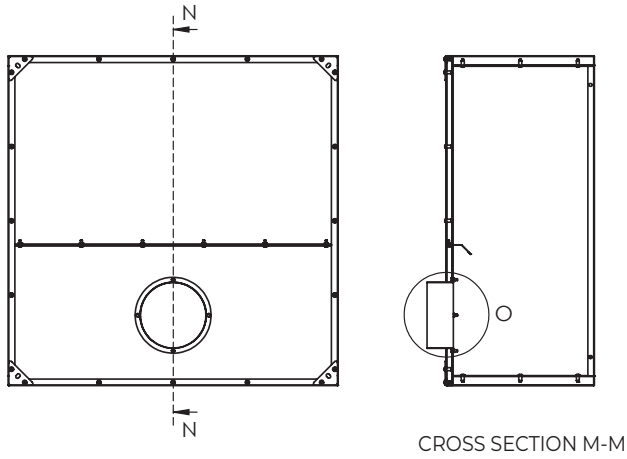

### Step IV

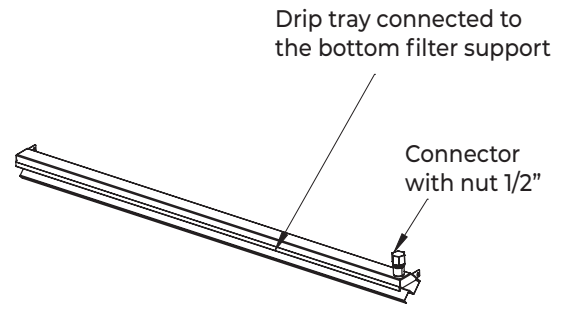

### Step V

