

# WALL MOUNTED EXTRACTOR HOOD, ANGLED

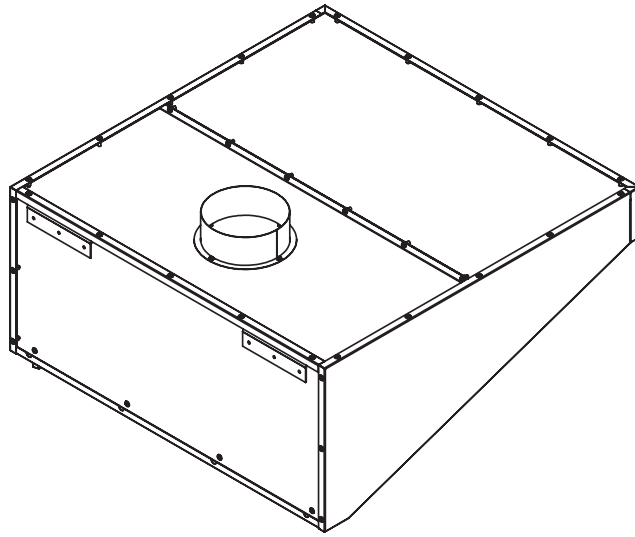

## Parts

Panel A - 1 pc.

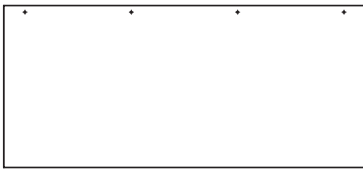

Ceiling A - 1 pc.

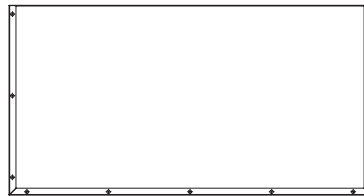

Ceiling B - 1 pc.

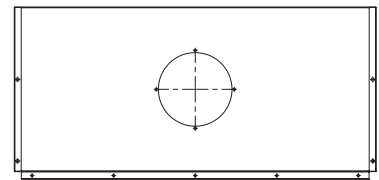

Top bracket filter - 1 pc.

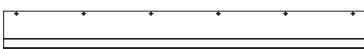

Dray tray - 1 pc.



Panel A, front - 1 pc.



Panel B - 1 pc.

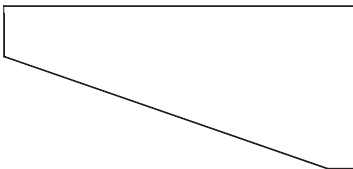

Exhaust pipe - 1 pc.

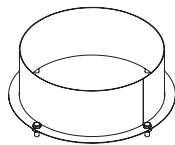

Wall mounting parts - 2 pcs.

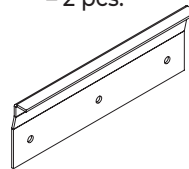

Cover - 2 pcs.

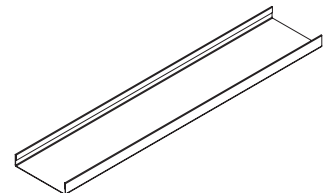

Panel B - 1 pc.

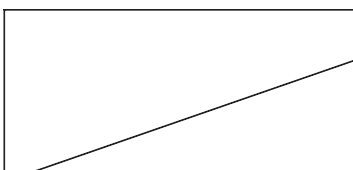

Washer screw  
M6x16 - 34 pcs.  
A = 1200 - 37

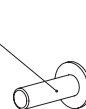

Nut  
M6 - 10 pcs.

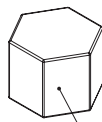

Nut 1/2" - 1 pc.

Hexagon head screw  
M6x16 - 10 pcs.  
A = 1200 - 11



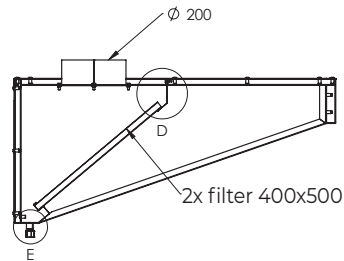
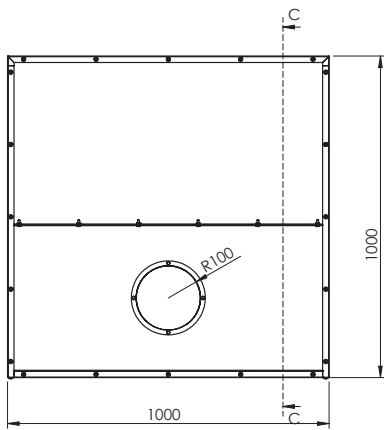
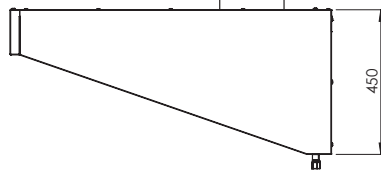
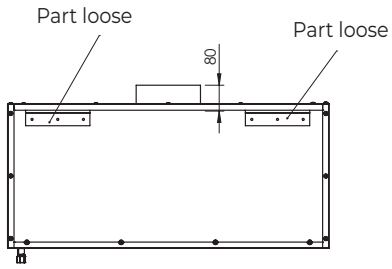
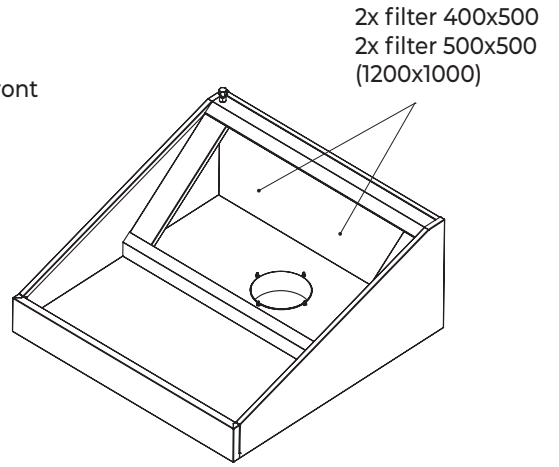
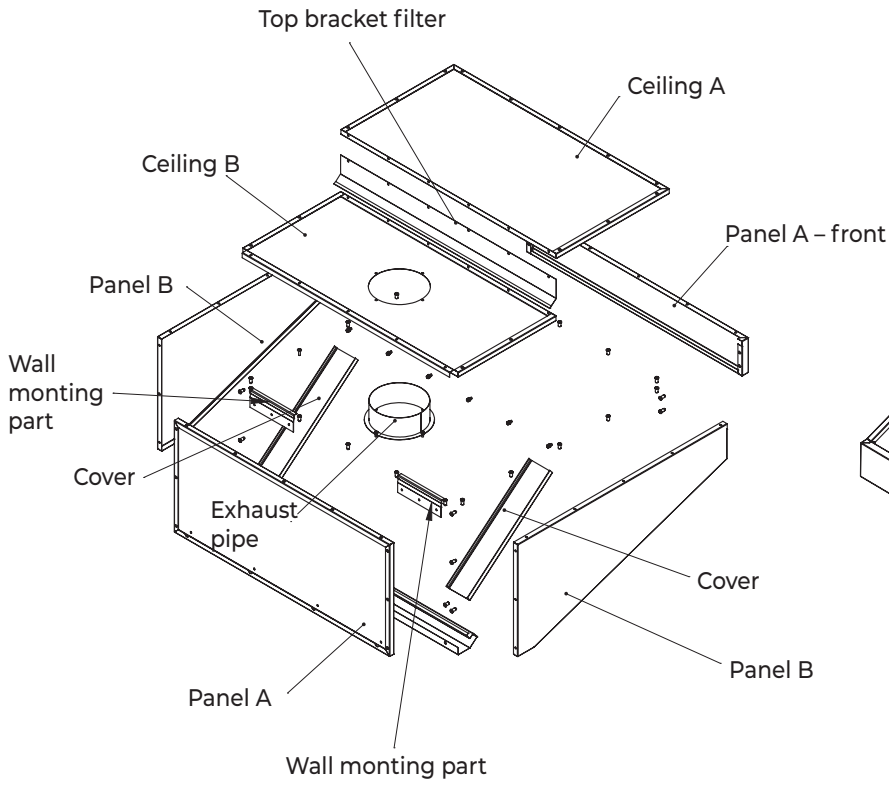

CROSS SECTION C-C

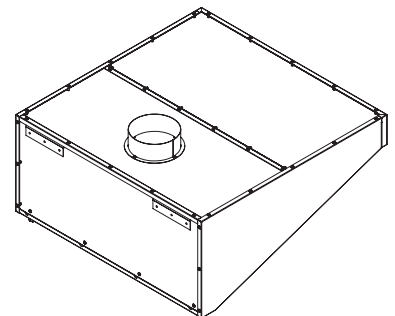
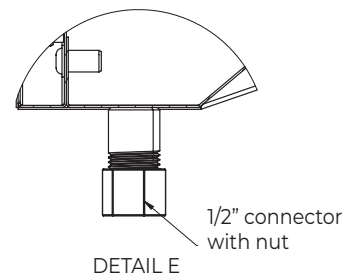
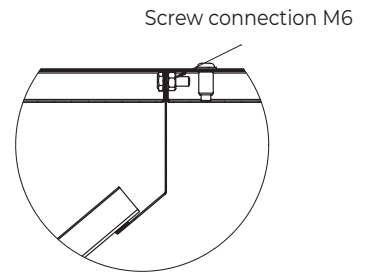

# Step I

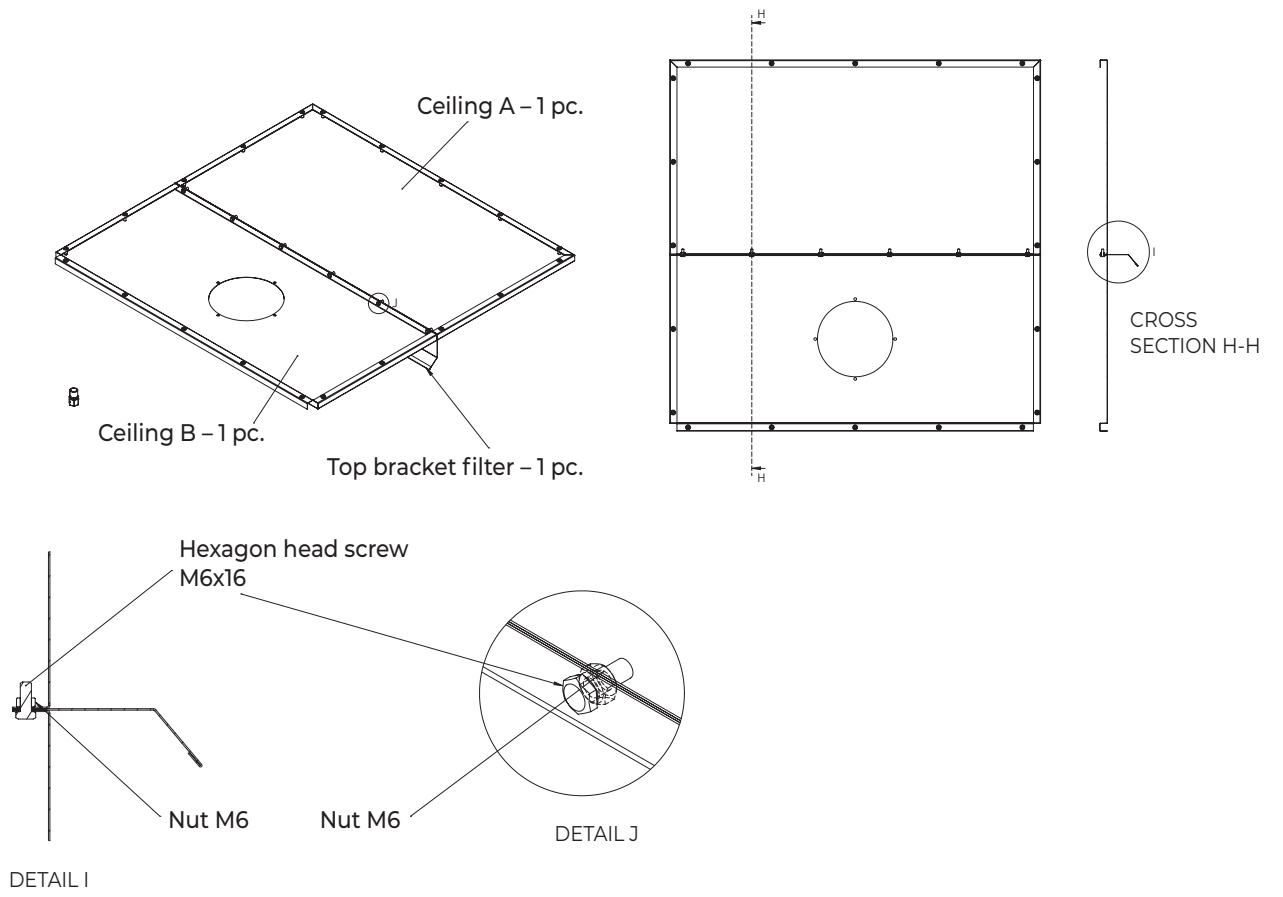

# Step II

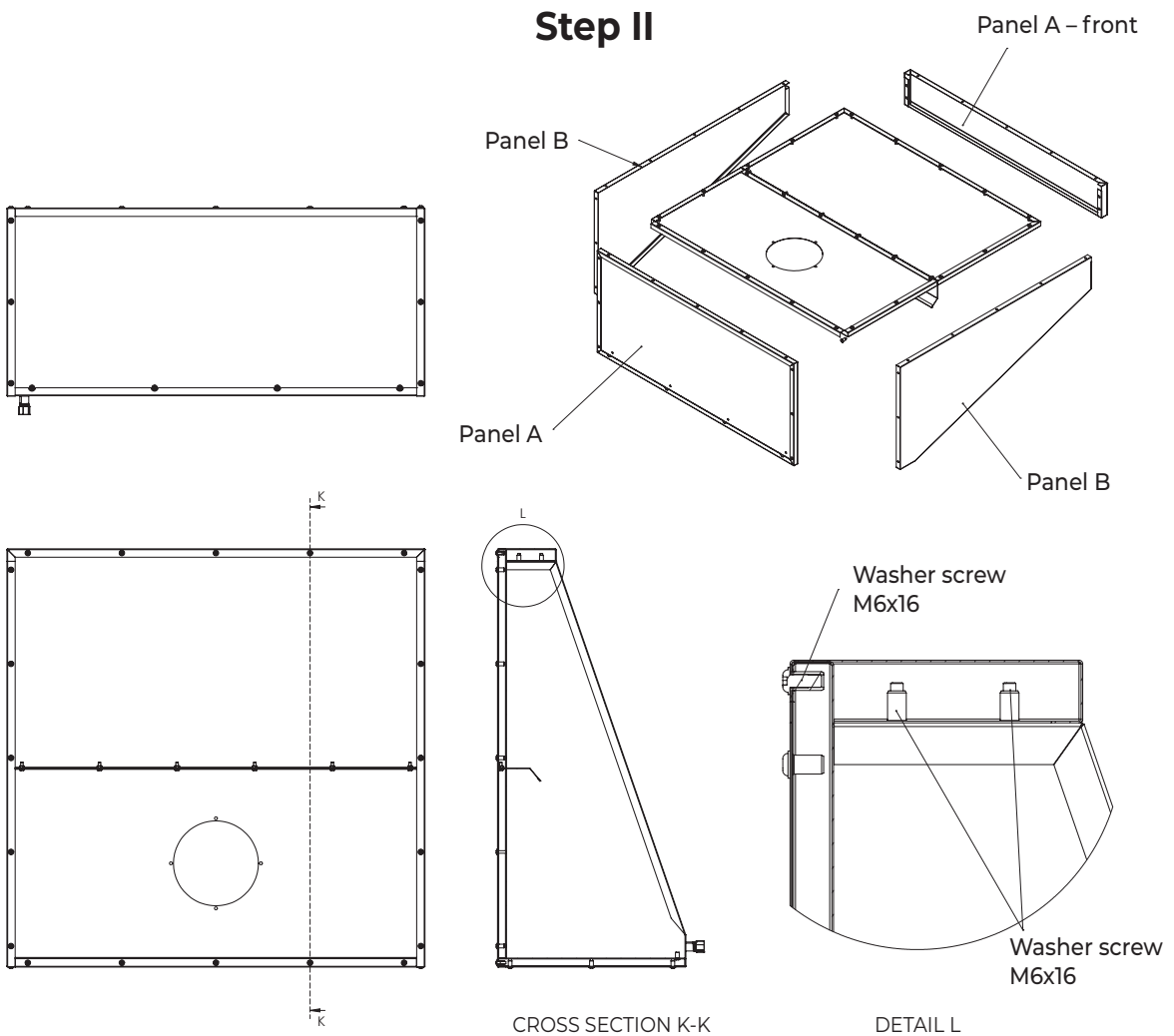

### Step III

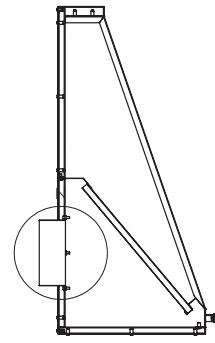
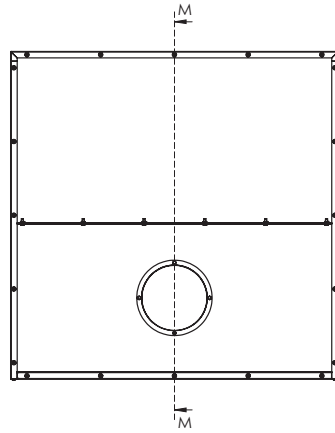

CROSS SECTION M-M

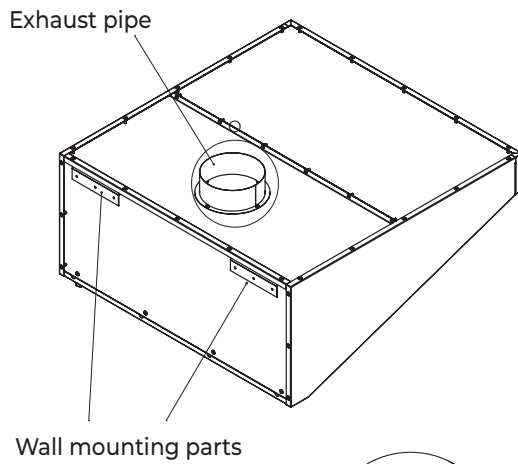

Wall mounting parts

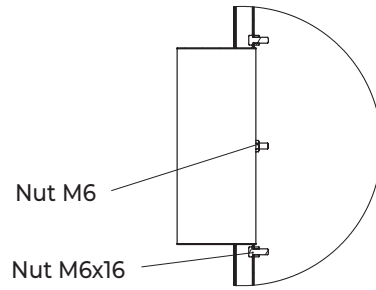

Nut M6

Nut M6x16

DETAIL N

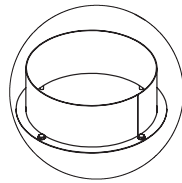

DETAIL O

---

### Step IV

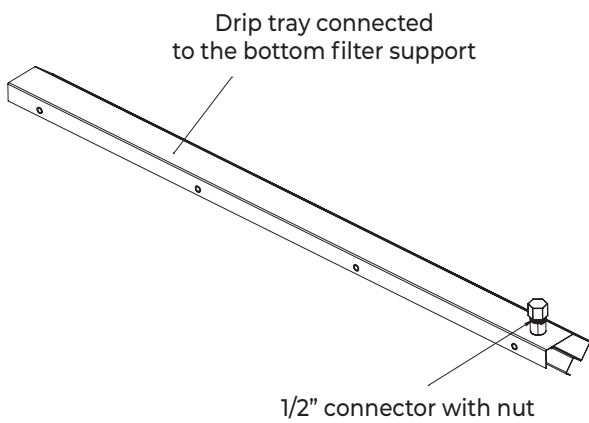

Drip tray connected to the bottom filter support

1/2" connector with nut

### Step V

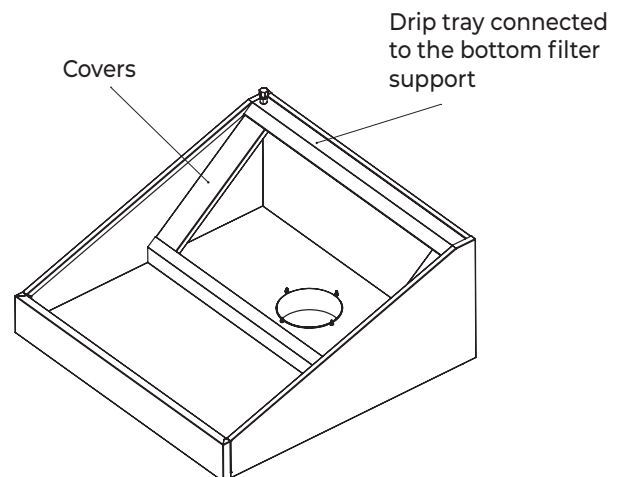

Covers

Drip tray connected to the bottom filter support